

SG-1 series

Single-stage (TESCOM)



SPEC.

공급 압력		Max. 4,500PSI
토출 압력		15,25,50,125,250 PSI
크기		132mm*128mm*152mm
재질	body	316 SS or BRASS (Nickel)
	Diaphragm	316 SS or Neoprene
	seat	PCTFE or Ployimide
사용	22R	N2, Ar, He, Air, CO2
가스&	22L	H2
연결부	23R	O2
무게		1.1Kg

- SG-1 시리즈의 제품은 동일제품군의 타사 제품에 비해 월등한 성능과 안정성을 보장합니다.
- 중요한 프로세스 또는 분석 응용 프로그램에 적용하여 최상의 성능을 발휘합니다.
- SG-1 시리즈는 다음과 같은 산업 표준/승인을 획득하였습니다.
- Oxygen cleaning in accordance with ASTM G93
- Passed the industry standards for oxygen ignition tests
- ASME B31 / ASME BPVC
- CGA E-4
- ISO 2503 / ISO 9090
- ISO 7291
- CRN

SG1 Series Regulator Drawing

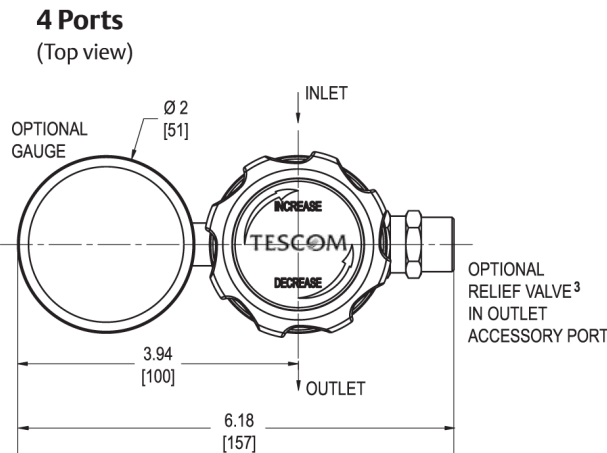
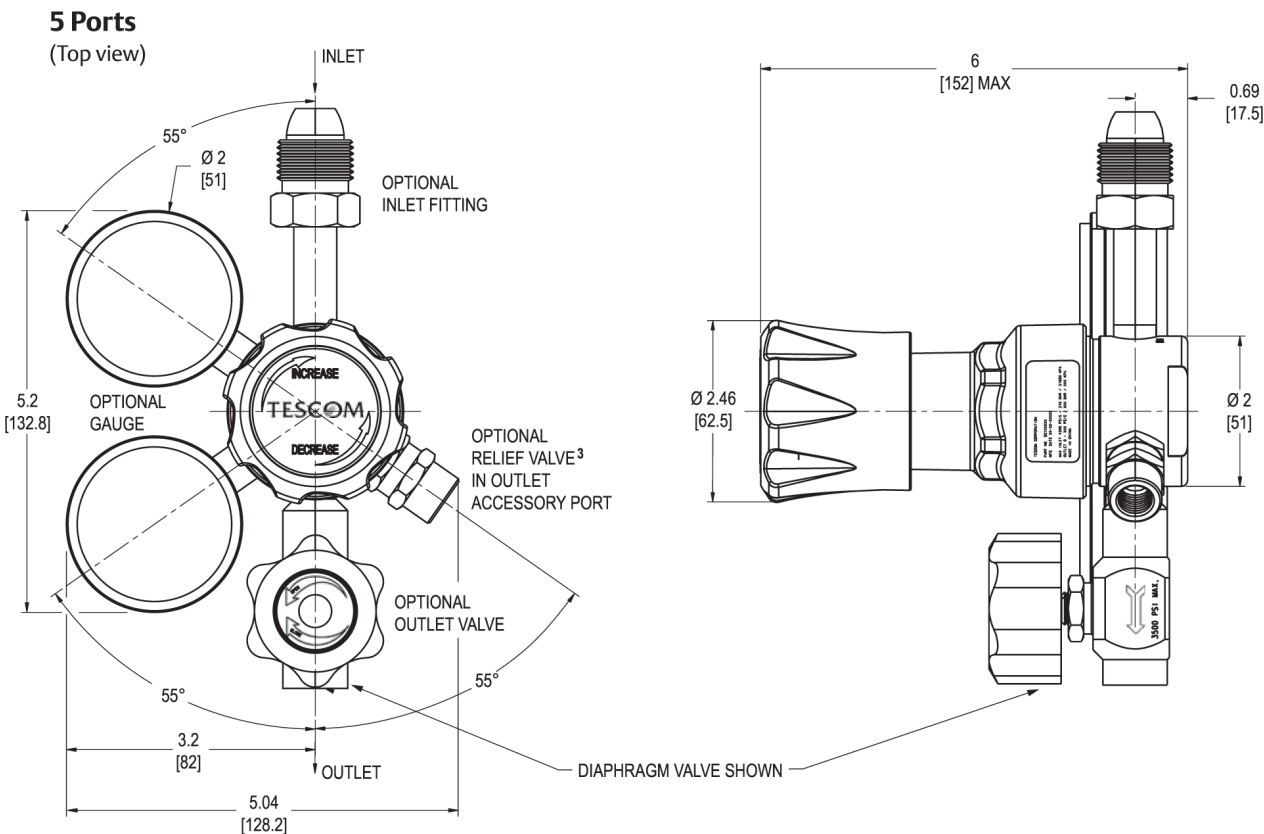

Bottom Mounting

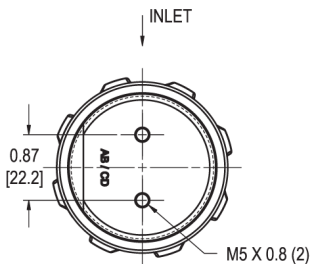

SG1 Series Regulator Part Number Selector

Base Model

Example for selecting a part number:

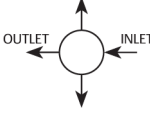
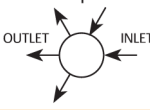
SG1	6	3	1	4	1	[Blank]	
BASIC SERIES	BODY MATERIAL	OUTLET PRESSURE RANGES	DIAPHRAGM MATERIAL	SEAL MATERIAL	PORTS (TOP VIEW)	FLOW C _v P1	SEAT MATERIAL
SG1	P – Nickel-Plated Brass 6 – 316L Stainless Steel	1 – 15 psig / 103 kPa / 1.0 bar ¹ 2 – 25 psig / 172 kPa / 1.7 bar 3 – 50 psig / 345 kPa / 3.4 bar 4 – 125 psig / 862 kPa / 8.6 bar 5 – 250 psig / 1724 kPa / 17.2 bar	1 – 316L Stainless Steel 2 – Neoprene	Teflon® Buna-N	4 – 4 port  5 – 5 port 	1 – 0.06 4500 psig 31,026 kPa 310 bar 2 – 0.2 3000 psig 20,684 kPa 207 bar	[Blank] – PCTFE V – Polyimide ²
<p>1. Consider a two-stage regulator (SG2) if using full range of inlet pressure capabilities 2. Per ASTM D 6456-99 Type II Class 1M (Meldin® 7021 or Vespel® SP-21)</p>							

Accessories

Extension to base model part number:

SG1XXXXXX — 06 A 1 A

BASE MODEL NUMBER	CYLINDER CONNECTIONS	GAUGES ⁴	RELIEF VALVE ³	OUTLET VALVE
	00 – None 01 – CGA 296 02 – CGA 350 C1 – CGA 510 03 – CGA 540 04 – CGA 580 05 – CGA 590 C2 – CGA 660 06 – DIN 477-1.1 07 – DIN 477-1.3 08 – DIN 477-1.5 09 – DIN 477-1.6 10 – DIN 477-1.7 11 – DIN 477-1.8 12 – DIN 477-1.9 13 – DIN 477-1.10 14 – DIN 477-1.14 15 – DIN 477-5.54 16 – DIN 477-5.57 17 – DIN 477-5.59 18 – BS 341 (2002) #01 19 – BS 341 (2002) #02 20 – BS 341 (2002) #03 21 – BS 341 (2002) #04 23 – BS 341 (2002) #06 24 – BS 341 (2002) #07 25 – BS 341 (2002) #08 27 – BS 341 (2002) #10 28 – BS 341 (2002) #11 30 – BS 341 (2002) #13 31 – BS 341 (2002) #14 32 – BS 341 (2002) #15	0 – None P – Plug(s) A – psi / kPa B – bar / psi	A – None P – Plug 1 – Teflon® Pipe-away	0 – None A – Diaphragm valve B – Needle valve
<p><i>Note: Cylinder connections are available in all world areas.</i></p>				

3. The relief valve is not intended to be a "Pressure Relief Device" as defined by ASME Boiler & Pressure Vessel Code - Section VIII, nor is it intended to be a "Safety Accessory" or "Pressure Limiting Device" as defined by the Pressure Equipment Directive (2014/68/EU). The relief valve is intended to indicate a potential problem with the regulator and prevent further damage to the regulator. The relief valve is not intended to protect the downstream process equipment.

4GAUGE PRESSURE RANGES	
OUTLET PRESSURE RANGE	OUTLET GAUGE PRESSURE RANGE
SG1X1XXXX – 15 psig / 103 kPa / 1.0 bar	0-30 psig / 200 kPa / 2 bar
SG1X2XXXX – 25 psig / 172 kPa / 1.7 bar	0-30 psig / 200 kPa / 2 bar
SG1X3XXXX – 50 psig / 345 kPa / 3.4 bar	0-60 psig / 400 kPa / 4 bar
SG1X4XXXX – 125 psig / 862 kPa / 8.6 bar	0-160 psig / 1100 kPa / 11 bar
SG1X5XXXX – 250 psig / 1724 kPa / 17.2 bar	0-300 psig / 2000 kPa / 20 bar
INLET PRESSURE RANGE	INLET GAUGE PRESSURE RANGE
All	6000 psig / 41,000 kPa / 400 bar

SG1 Series Regulator Flow Charts

$C_v = 0.06$ Model

Metal Diaphragm

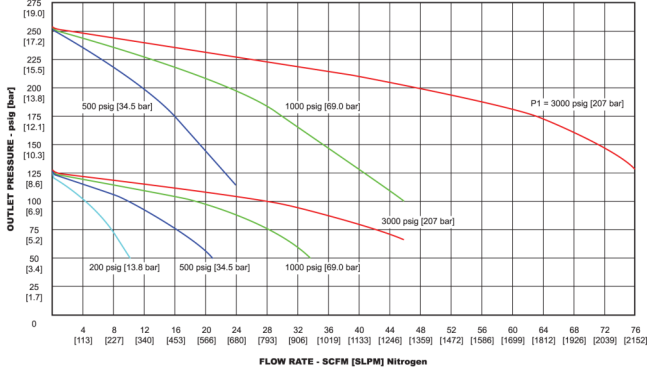

$C_v = 0.06$ Model

Neoprene Diaphragm

