

Male Branch Tee

ATBM-N

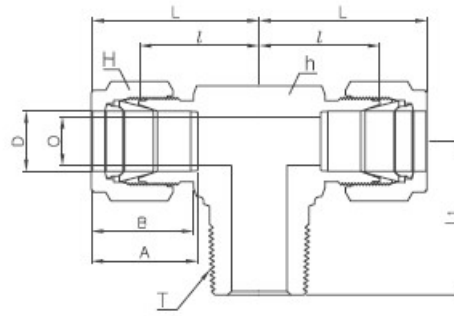

Connects metric tube to female NPT thread

Part No.	Tube O.D.	T	O	Width Across Flat		A	B	I	L	L1
	D	NPT	Min	h	H					
ATBM3M-2N	3	1/8	2.4	12.7	12	12.9	15.3	17	23.6	17.8
ATBM3M-4N	3	1/4	2.4	12.7	12	12.9	15.3	18	24.6	23.4
ATBM4M-2N	4	1/8	2.4	12.7	12	13.7	16.1	18.8	25.4	18.8
ATBM4M-4N	4	1/4	2.4	12.7	12	13.7	16.1	18.8	25.4	23.4
ATBM6M-2N	6	1/8	4.8	12.7	14	15.3	17.7	19.6	27	18.8
ATBM6M-4N	6	1/4	4.8	14.2	14	15.3	17.7	19.6	27	23.4
ATBM6M-6N	6	3/8	4.8	17.5	14	15.3	17.7	22.4	29.8	26.2
ATBM6M-8N	6	1/2	4.8	20.6	14	15.3	17.7	24.4	31.8	33
ATBM8M-2N	8	1/8	4.8	14.3	16	16.2	18.6	21.3	28.8	19.8
ATBM8M-4N	8	1/4	6.4	14.3	16	16.2	18.6	21.3	28.8	24.4
ATBM8M-6N	8	3/8	6.4	17.5	16	16.2	18.6	23.1	30.6	26.2
ATBM8M-8N	8	1/2	6.4	20.6	16	16.2	18.6	25.1	32.6	33
ATBM10M-2N	10	1/8	4.8	17.5	19	17.2	19.5	23.9	31.5	23.6
ATBM10M-4N	10	1/4	7.1	17.5	19	17.2	19.5	23.9	31.5	26.2
ATBM10M-6N	10	3/8	7.9	17.5	19	17.2	19.5	23.9	31.5	26.2
ATBM10M-8N	10	1/2	7.9	20.6	19	17.2	19.5	25.9	33.5	33
ATBM12M-2N	12	1/8	4.8	20.6	22	22.8	22	25.9	36	23.6
ATBM12M-4N	12	1/4	7.1	20.6	22	22.8	22	25.9	36	28.2
ATBM12M-6N	12	3/8	9.5	20.6	22	22.8	22	25.9	36	28.2
ATBM12M-8N	12	1/2	9.5	20.6	22	22.8	22	25.9	36	33
ATBM12M-12N	12	3/4	9.5	27	22	22.8	22	29.7	39.8	36.8
ATBM16M-6N	16	3/8	9.5	25.4	25	24.4	22	27.9	38	30.2
ATBM16M-8N	16	1/2	11.9	25.4	25	24.4	22	27.9	38	35.1
ATBM16M-12N	16	3/4	12.7	27	25	24.4	22	29.7	39.8	36.8
ATBM18M-8N	18	1/2	11.9	27	30	24.4	22	29.7	39.8	36.8
ATBM18M-12N	18	3/4	15.1	27	30	24.4	22	29.7	39.8	36.8
ATBM20M-8N	20	1/2	11.9	34.92	32	26	22	34.5	44.6	41.7
ATBM20M-12N	20	3/4	15.9	34.92	32	26	22	34.5	44.6	41.7
ATBM22M-12N	22	3/4	15.9	34.92	32	26	22	34.5	44.6	41.7
ATBM22M-16N	22	1	18.3	34.92	32	26	22	34.5	44.6	46.5
ATBM25M-12N	25	3/4	15.9	34.92	38	31.3	26.5	36.8	49.1	41.7
ATBM25M-16N	25	1	21.8	34.92	38	31.3	26.5	36.8	49.1	46.5