

Union Elbow AL

M Tube Fitting

1 / 1
PAGE

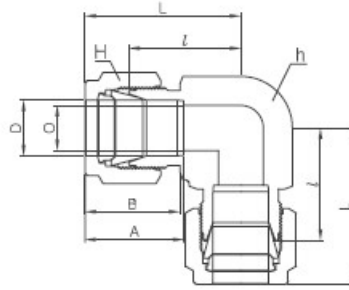

Connects fractional tube

Part No.	Tube O.D.		O Min	Width Across Flat				A	B	I	L
	D			h		H					
	in	mm	in	mm	in	mm					
AL - 1	1/16	1.59	1.27	3/8	9.52	5/16	7.93	8.63	10.92	14	17.88
AL - 2	1/8	3.17	2.28	3/8	9.52	7/16	11.11	12.7	15.24	15.74	22.35
AL - 3	3/16	4.76	3.04	1/2	12.7	1/2	12.7	13.71	16	17.78	24.38
AL - 4	1/4	6.35	4.82	1/2	12.7	9/16	14.28	15.24	17.78	19.55	26.92
AL - 5	5/16	7.93	6.35	9/16	14.28	5/8	15.87	16.25	18.54	21.33	28.7
AL - 6	3/8	9.52	7.11	5/8	15.87	11/16	17.46	16.76	19.3	23.11	30.48
AL - 8	1/2	12.7	10.41	13/16	20.64	7/8	22.22	22.86	21.84	25.9	36.06
AL - 10	5/8	15.87	12.7	15/16	23.81	1	25.40	24.38	21.84	28.7	38.8
AL - 12	3/4	19.05	15.74	1-1/16	26.98	1-1/8	28.58	24.38	21.84	29.71	39.87
AL - 14	7/8	22.22	18.28	1-3/8	34.92	1-1/4	31.75	25.9	21.84	34.54	44.7
AL - 16	1	25.4	22.35	1-3/8	34.92	1-1/2	38.1	31.24	26.41	36.83	49.02
AL - 20	1-1/4	31.75	27.68	1-11/16	42.86	1-7/8	47.63	41.14	38.86	44.5	66.54
AL - 24	1-1/2	38.1	34.03	2	50.8	2-1/4	57.15	50.03	45.21	50.8	77.97
AL - 32	2	50.8	45.97	2-3/4	69.85	3	76.2	67.56	62.73	69.8	107.18

Connects metric tube

Part No.	Tube O.D.		O Min	Width Across Flat		A	B	I	L
	D			h	H				
AL - 2M	2		1.7	9.5	12	12.9	15.3	15.7	22.3
AL - 3M	3		2.4	9.5	12	12.9	15.3	15.7	22.3
AL - 4M	4		2.4	12.7	12	13.7	16.4	18.8	25.4
AL - 6M	6		4.8	12.7	14	15.3	17.7	19.6	27
AL - 8M	8		6.4	14.3	16	16.2	18.6	21.3	28.8
AL - 10M	10		7.9	17.5	19	17.2	19.5	23.9	31.5
AL - 12M	12		9.5	20.6	22	22.8	22	25.9	36
AL - 15M	15		11.9	25.4	25	24.4	22	28.7	38.8
AL - 16M	16		12.7	25.4	25	24.4	22	28.7	38.8
AL - 18M	18		15.1	27.0	30	24.4	22	29.7	39.8
AL - 20M	20		15.9	34.92	32	26	22	32.5	42.6
AL - 22M	22		18.3	34.92	32	26	22	32.5	42.6
AL - 25M	25		21.8	34.92	38	31.3	26.5	36.8	49.1
AL - 28M	28		21.8	41.0	46	36.6	36.6	43.2	64
AL - 32M	32		28.6	46.0	50	42	41.6	49.3	72.3
AL - 38M	38		33.7	55.0	60	49.4	47.9	56.4	84